

## Leonardo 11Kw Inset Pellet Stove

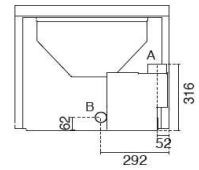

OPTIONAL

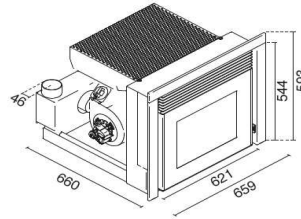
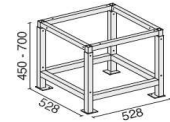

A = Ø 80 mm Scarico fumi / Flue / Cheminée / Rauchabzug  
Evacuación de humos / Descarga de humos  
B = Ø 51 mm Aria combustione / Combustion air / Air de combustion /  
Verbrennungsluft / Aire para la combustión / Ar de combustão

### Technical Data

Total introduced power: max 11kW – min 2.9kW  
Nominal heat output: max 9.5kW – min 2.7kW  
Efficiency: Pmax 85% – Pmin 87.5%  
CO emission at 13% O2: Pmax 0,012% - Pmin 0,047%  
Pellet consumption: max 2.4kg/h - min 0,6kg/h  
Reservoir capacity: 15kg  
Heatable room volume: 60 – 190 mc  
Minimum distances from combustibles: side 10cm - back 10 cm - front 100 cm  
Weight: 105.7kg  
Complies with: EN14785 - BImSchV II - 15a B-VG - LRV/VKF  
Flue Outlet: Rear  
Remote control: included

### Features

Front glass door with black etching  
Forced ventilation  
5 operating power levels  
Menu display in 6 languages  
Cast iron combustion chamber  
Installed on extractor runners  
Removable handle  
Remote control supplied  
Safety thermostat  
Suitable for external thermostat  
Safety Manostat  
Timer Thermostat

# Hamco

STOVES

Hamco Heating Ltd  
Cloncollig  
Church Road  
Tullamore  
Co. Offaly  
05793 21302  
[info@hamco.ie](mailto:info@hamco.ie)  
[www.hamco.ie](http://www.hamco.ie)